



# Montageanleitung/ Instruction Manual GIGANT Sperrklappe/ Locking Clip

ETA-10/0189

mit Bauzulassung (EU+DE)

Art.- Nr. Z525

with construction technical approval (EU+DE)

Bohrbild im Längsholz wie bei Montage ohne Sperrklappe/  
The drilling template in the header side grain is the same assemblage as without clip lock

Bohrbild im Hirnholz/  
Drilling template in end grain  
GIGANT 120/40

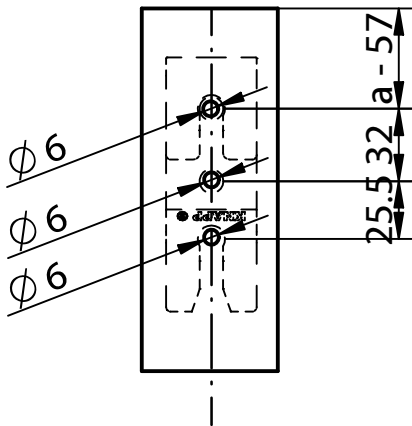

3x KNAPP SK Schrauben 10x120

Bohrbild im Hirnholz/  
Drilling template in end grain  
GIGANT 150/40

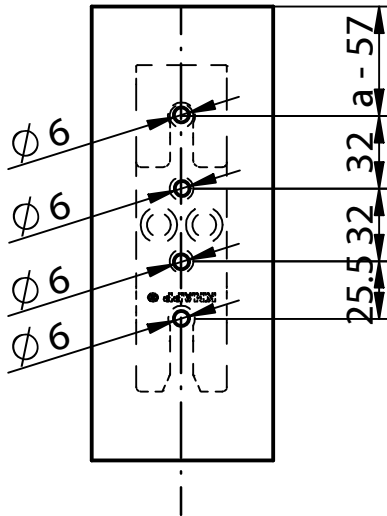

4x KNAPP SK Schrauben 10x120

Bohrbild im Hirnholz/  
Drilling template in end grain  
GIGANT 180/40

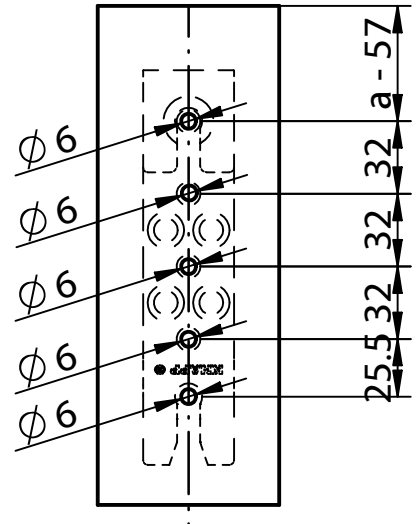

5x KNAPP SK Schrauben 10x120

## Montage der Sperrklappe/ Assembled clip lock

1. Sperrklappe im Hauptträger einlegen/  
to wire the clip lock into the header

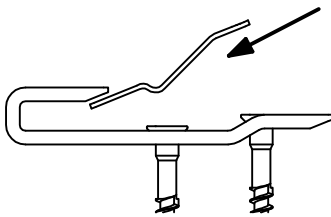

2. Sperrklappe durch Schraube am  
Verbinder befestigen/ to connect the  
GIGANT and clip lock with screw

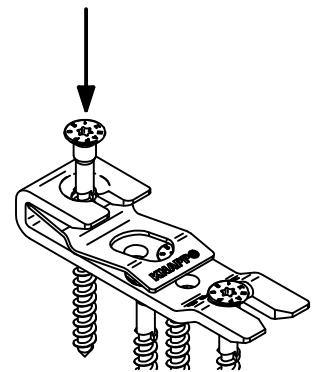
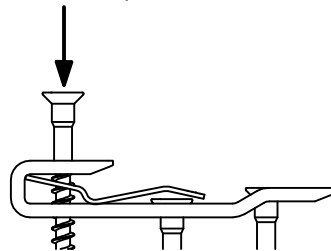

3. Verbinder zusammenfügen/  
to assemble the connector

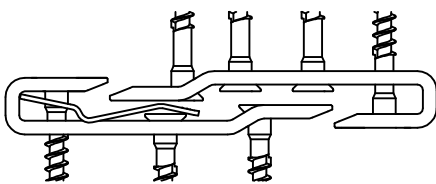

4. Sperrklappe rastet ein/  
clip lock clicks in place

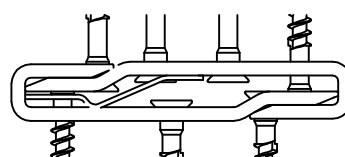

"CLICK"

OK ✓

Diese Zeichnung ist Eigentum der Knapp GmbH

© Knapp GmbH. Alle Maße in mm - Irrtümer, Druckfehler und Änderungen vorbehalten / all measures in mm - Errors excepted. VERSION 03 08.08.2013

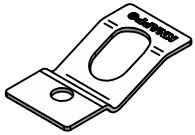

ETA-10/0189

# Notice de montage Platine de verrouillage GIGANT

Réf. Z525

Avec Avis Technique Européen

Détail de perçage sur bois de fil idem au montage sans platin de verrouillage -  
Attention, le montage, avec goupille est considéré comme indémontable

Détail de perçage sur  
bois de bout:  
GIGANT 120

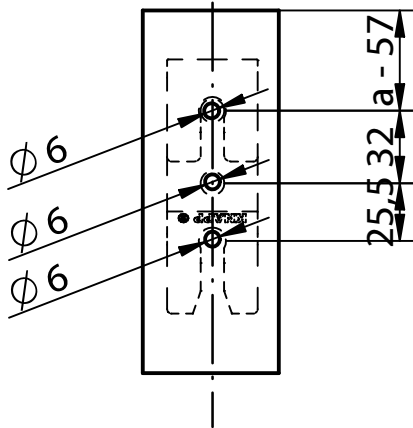

3x vis tête fraisée KNAPP SK 10x120

Détail de perçage sur  
bois de bout:  
GIGANT 150

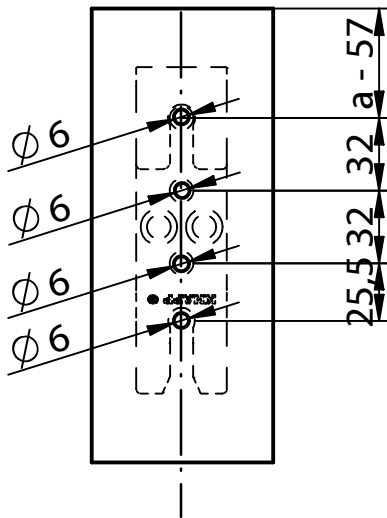

4x vis tête fraisée KNAPP SK 10x120

Détail de perçage sur  
bois de bout:  
GIGANT 180

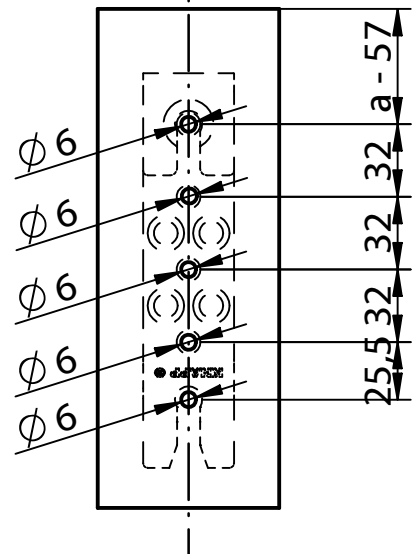

5x vis tête fraisée KNAPP SK 10x120

## Montage de platine de verrouillage:

1. Positionner la platine de verrouillage  
coté poutre principale

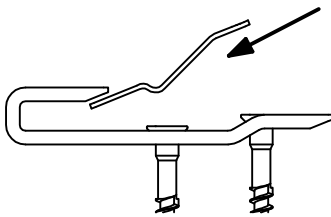

2. Visser la platine de verrouillage sur la ferrure

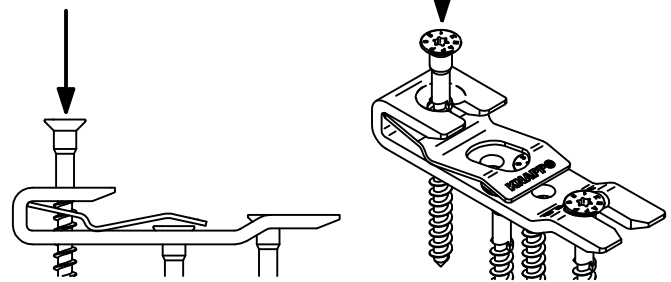

3. Emboîter les deux ferrures  
l'une sur l'autre

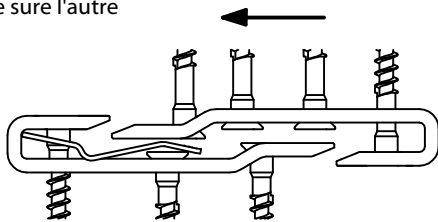

4. La platine de verrouillage  
s'enclenche automatiquement

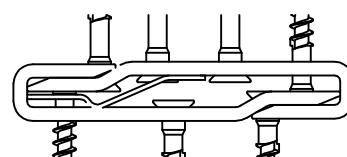

"CLIC"

OK

Ce dessin est la propriété de Knapp GmbH.

© Knapp GmbH. Toutes dimensions en mm - sauf erreurs, fautes d'impression ou modifications techniques. VERSION 03 08. 08. 2013