

Art.-Nr.

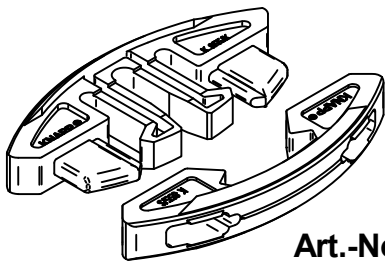

Art.-No. K855

Instruction Manual FIYU® Fast

Plug-in connector

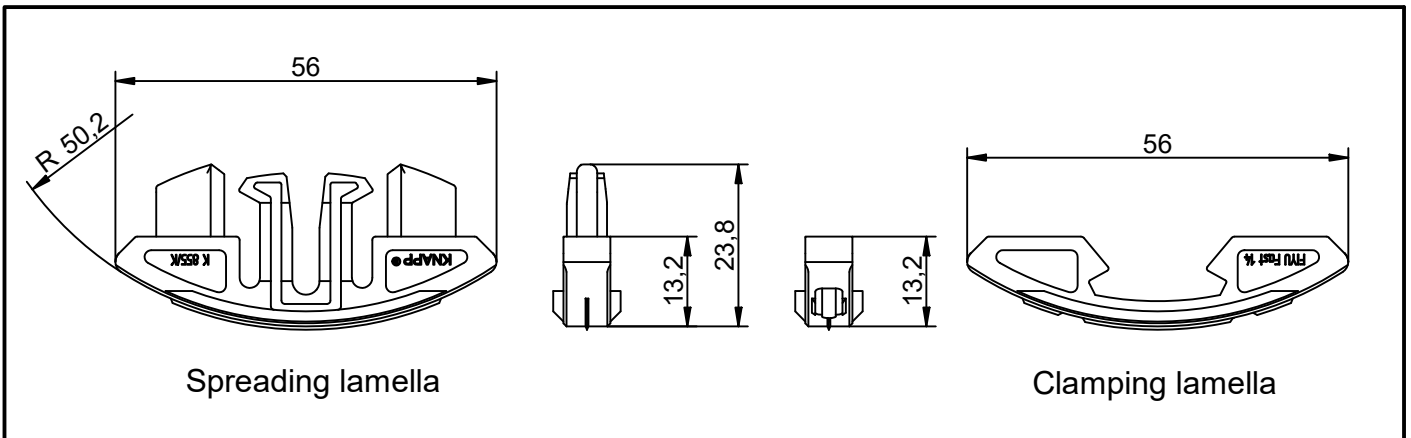

1. Milling

Undercut milled groove for FIYU connectors

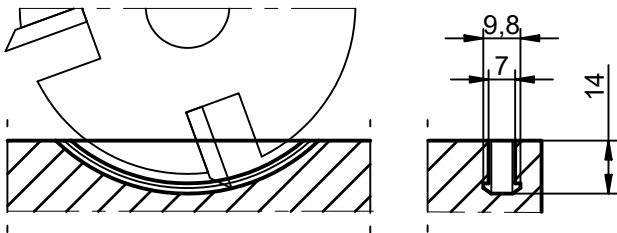

Part A und Part B

2. Positioning

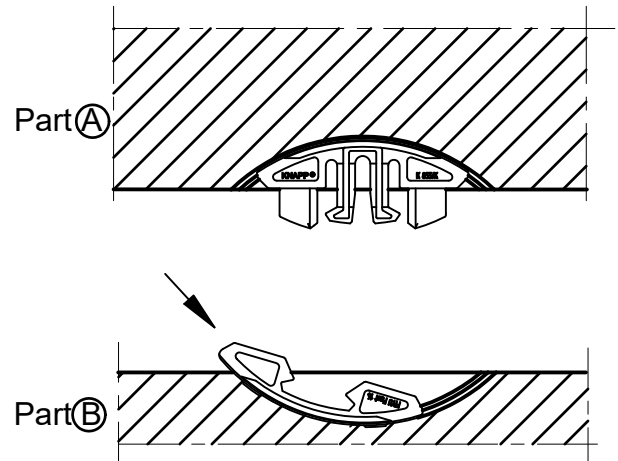

Position the connector precisely

3. Assembling

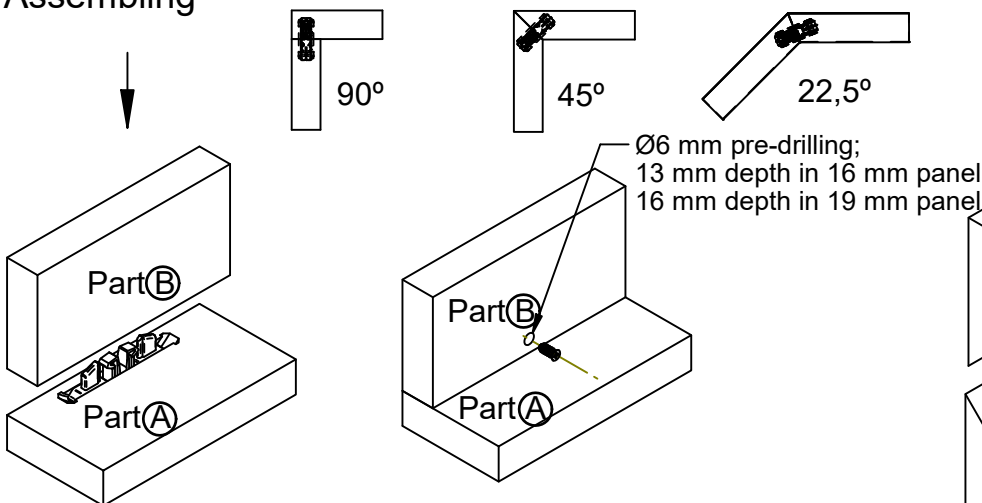

This drawing is the exclusive property of Knapp GmbH.

© Knapp GmbH. All measures in mm - Errors excepted. VERSION 01 09. 09. 2022

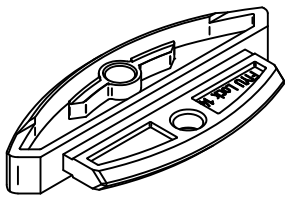

Instruction Manual

FIYU® LOCK

Art.-No. K856/S

Plug-in connector

FIYU® Lock - Plug-in connector

Tensioning screw M5x13
Art.-No. K857

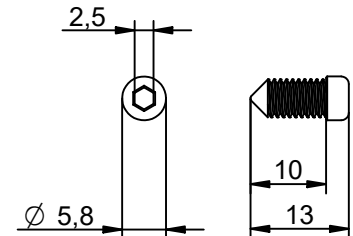
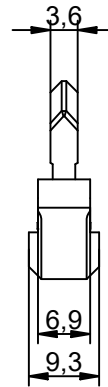
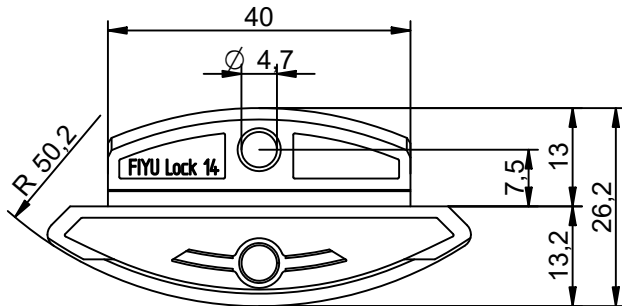

1. Milling part Ⓐ

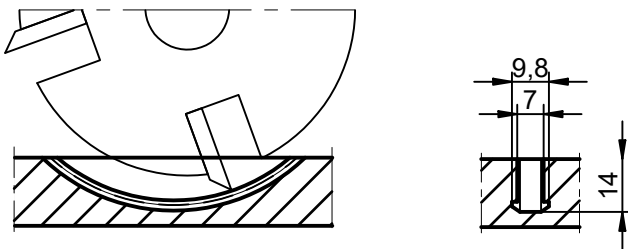

2. Drilling/milling part Ⓑ

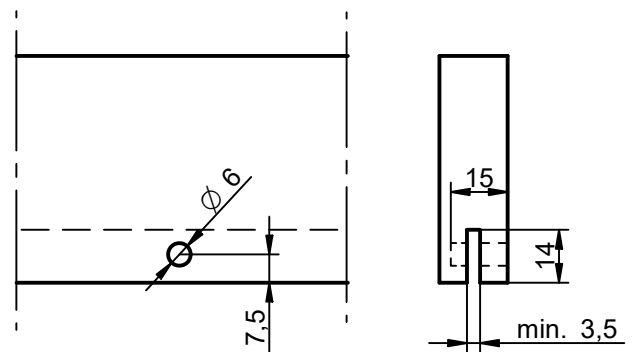

3. Plug-in

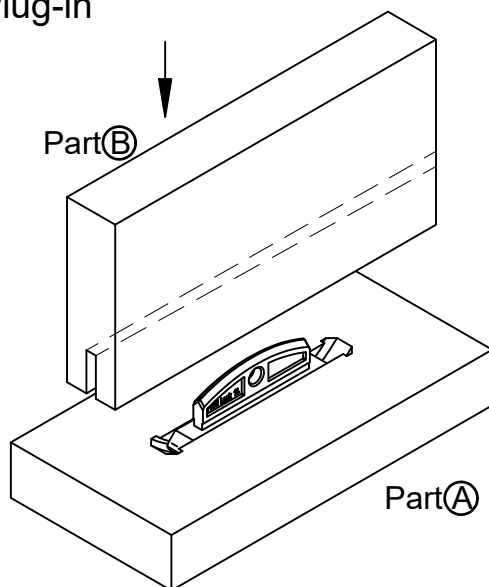

4. Screwing together

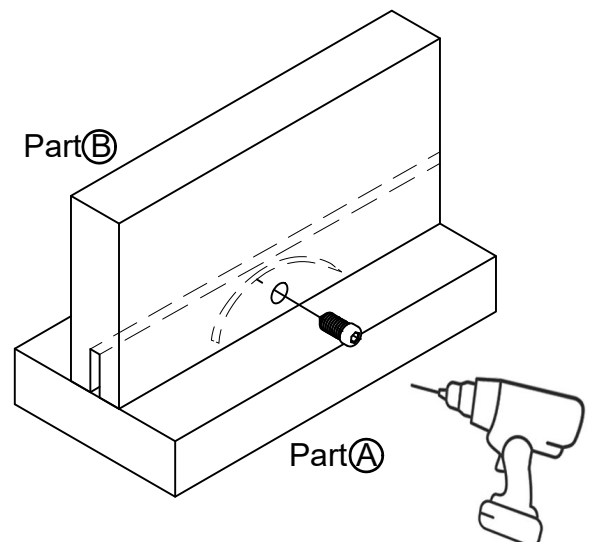

This drawing is the exclusive property of Knapp GmbH.

© Knapp GmbH. All measures in mm - Errors excepted. VERSION 01 09. 09. 2022