

Art.-Nr. K026

Montageanleitung

METAL

Schiebeverbinder

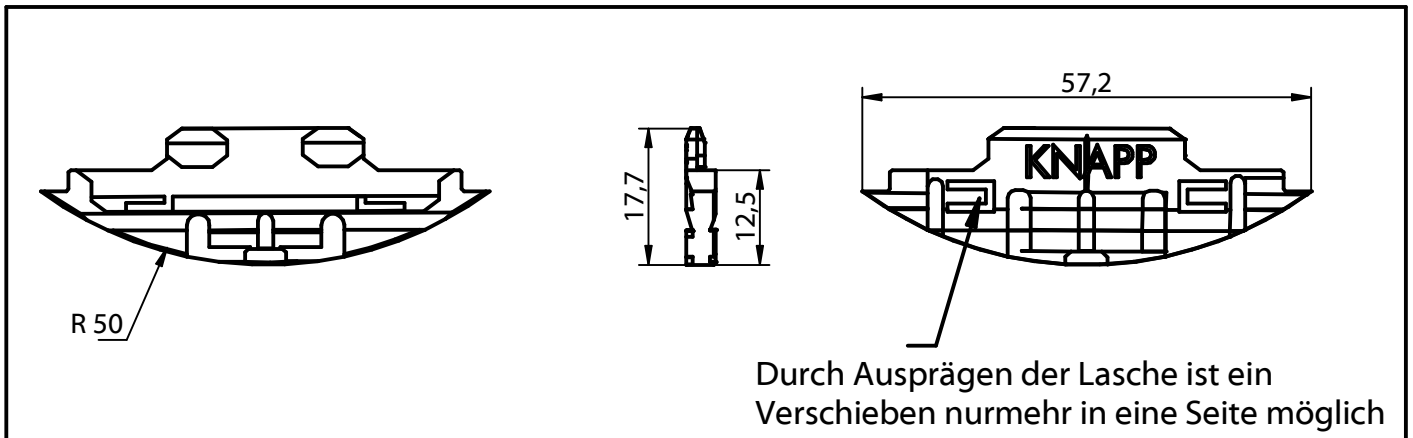

1. Fräsen

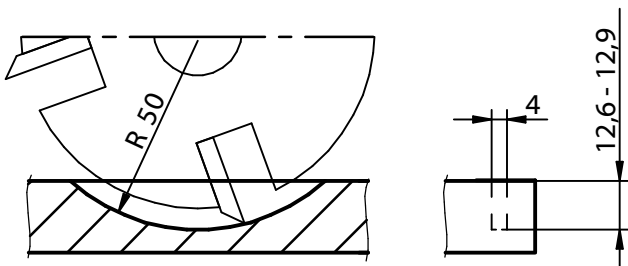

2. Einlegen

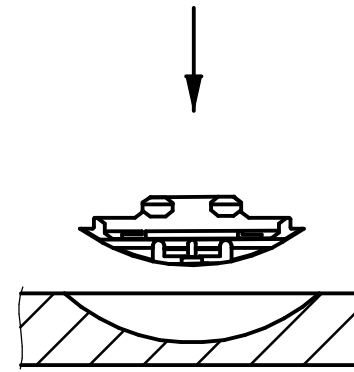

3. Verschrauben

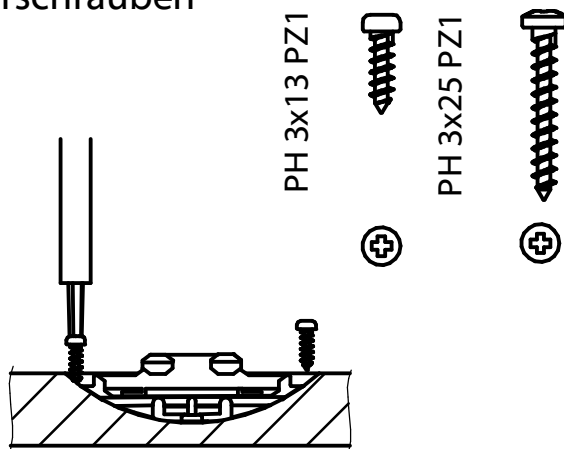

Verschrauben in der Schmalseite mit 3x13
in der Breitseite mit 3x25 KNAPP PH Schrauben

4. Montieren

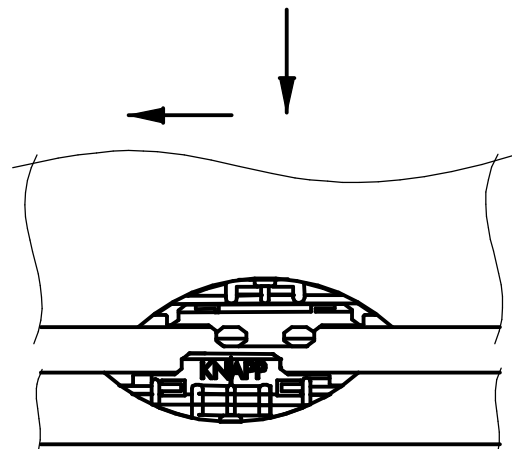

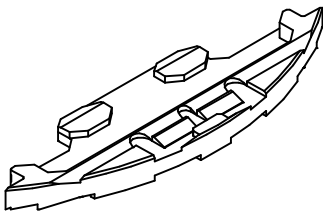

Art.-No. K026

Instruction Manual

METAL

Slide connectors

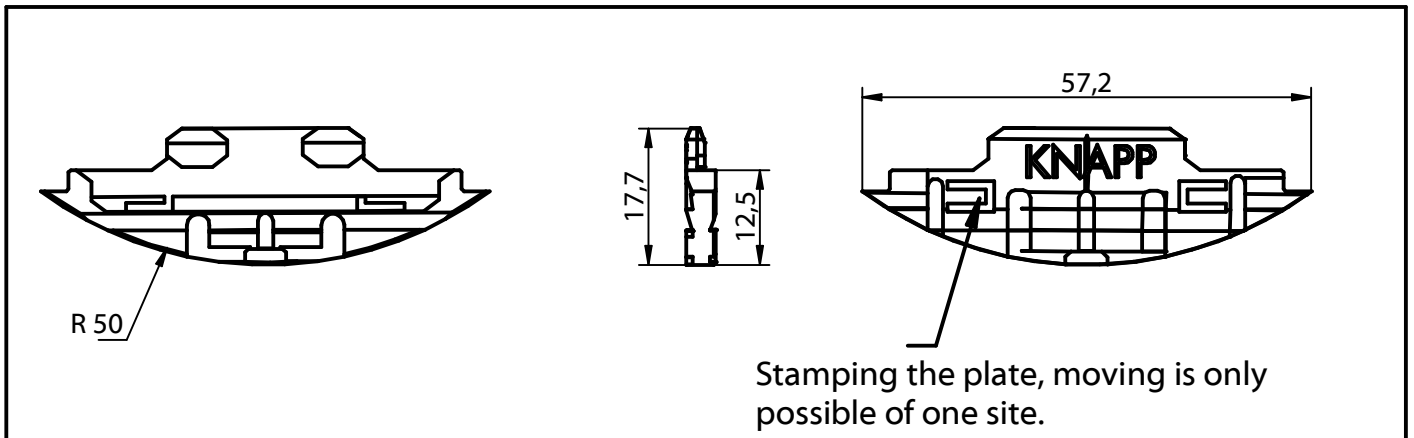

1. Routing

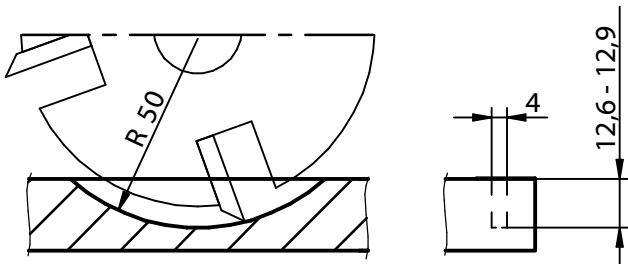

2. to place in

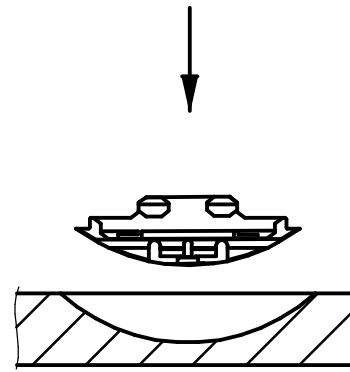

3. Screw in

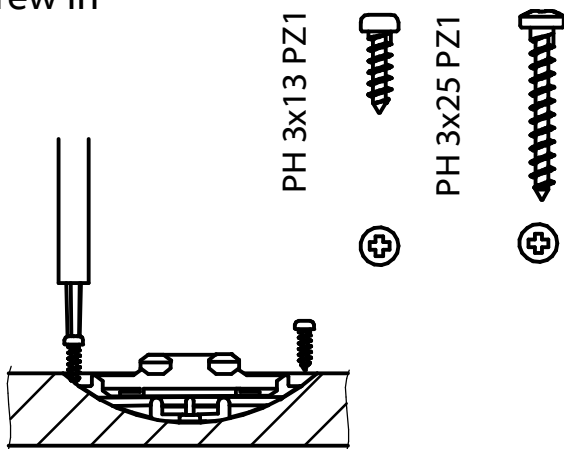

Screwing on the narrow side with 3x13
on the long side 3x25 KNAPP PH screws

4. Assemble

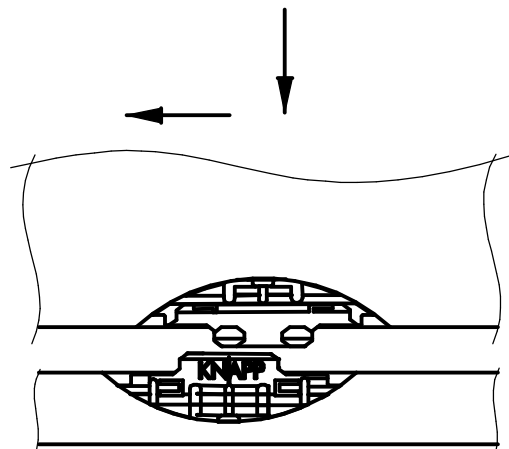

This drawing is the exclusive property of Knapp GmbH.

© Knapp GmbH. All measures in mm - Errors excepted. VERSION 04 13.05.2019

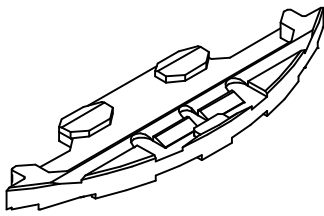

Réf. K026

Notice de montage

METAL

assembleur à coulisser

En frappant la languette pré-poinçoné il est possible de créer une butée d'arrêt dans un sens.

1. Fraiser

2. Insérer

3. Visser

PH 3x13 PZ1

PH 3x25 PZ1

Vissage sur face avec vis de 3x13 et vissage en bout de panneau avec vis 3x25 KNAPP PH

4. Monter

Ce dessin est la propriété de Knapp GmbH.

© Knapp GmbH. Toutes dimensions en mm - sauf erreurs, fautes d'impression ou modifications techniques. VERSION 04 13. 05. 2019